



FPGWORLD.COM

visair

PASS THROUGH 900 OPEN FRONT AND REAR HEATED

RANGE	VISAIR PASS THROUGH
TEMPERATURE	HEATED
MODEL	IN-H-PT-A001
FRONT	OPEN FRONT
INSTALLATION	FREESTANDING
HEIGHT	1074mm
WIDTH	924mm
DEPTH	632mm

RECOMMENDED CORE PRODUCT TEMPERATURE	+65°C - +80°C
ENVIRONMENTAL TEST CONDITIONS	22°C / 65% RH

FEATURES

- High energy efficiency: 1.74 kWh per hour (average)**
- Recommended core product temperature +65°C - +80°C**

- Robust open front display, powdercoated satin black for a sleek finish

Open Front/Open Rear Heated Display

- Three full-width display levels: two fixed **IWave** quartz infrared shelves and heated base
- Each **IWave** shelf is brushed stainless steel and is fitted with a product stop lip and ticket strip to front: 30mm (height), with caution decal applied.
- Both shelves and base are angled to support gravity feed.
- Pluggable 25,000 hour LED lighting system at 2758 lumens per metre in cabinet top and to each shelf

Operational Excellence

- FPG **IWave** heating technology uses low-wattage quartz infrared elements complemented with a heating coil in the base for even temperature distribution and extended shelf life
- Safer for staff - display surfaces are maintained < +65°C and the internal air temperature is lower than in many fan-assisted cabinets
- No noise pollution - this cabinet runs silently
- Positioned on counter top
- Modular - position adjacent cabinets to extend capacity



IWave

Showing : Visair Pass Through heated 924mm with two **IWave** shelves and base

OPTIONS & ACCESSORIES

Contact a [FPG Sales Representative](#) for our full range, including:

- Custom colour
- Custom joinery solution
- Branded decals



Indicates sustainability benefits



Please contact FPG to discuss your requirements for meeting country-specific standards.

FPGWORLD.COM



FPGWORLD.COM

visair

PASS THROUGH 900 OPEN FRONT AND REAR HEATED

HEATED DATA

MODEL	RECOMMENDED CORE PRODUCT TEMPERATURE	ENVIRONMENTAL TEST CONDITIONS	I/WAVE HEATING
IN-H-PT-A001	+65°C - +80°C	22°C / 65% RH	Low-wattage infrared quartz elements

ELECTRICAL DATA

MODEL	VOLTAGE	PHASE	CURRENT ¹	E24H ² (kWh)	kWh per hour (average)	kWh per hour per m ²	MAINS		LED LIGHTING		
							CONNECTION	CONNECTION PLUG ³	HOURS	LUMENS	COLOUR
IN-H-PT-A001	220-240 V	Single	10.2 A	41.76	1.74	1.64	3 metre 3 core cable	15 amp 3 pin plug	25,000	2758 per metre	Natural

¹Current is the maximum potential current draw at 240v with +5% element tolerance.

²Nominal power consumption per 24h. i.e: 230V at 0% energy tolerance.

³Please advise country to change plug specification.

CAPACITY, ACCESS & CONSTRUCTION

MODEL	DISPLAY AREA	LEVELS	ACCESS FRONT	ACCESS REAR	CHASSIS CONSTRUCTION	IP RATING
IN-H-PT-A001	1.06 m ²	2 Shelves + Base	Open front	Open rear	Stainless 304 and mild steel	IP 22

DIMENSIONS

MODEL	H x W x D mm (Uncrated)	MASS (Uncrated)
IN-H-PT-A001	1074 x 924 x 632	149 kg

Crated weights and dimensions vary. Please contact us for information on your shipment.

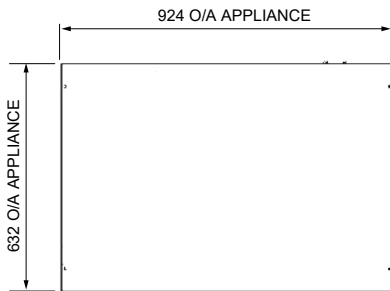

PLAN VIEW

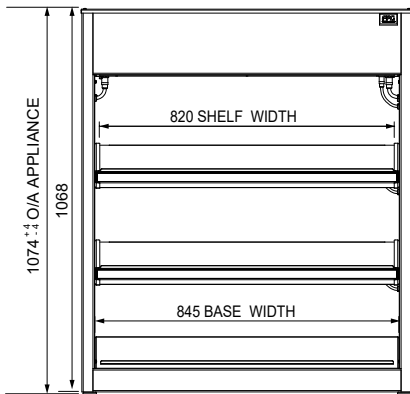

FRONT ELEVATION

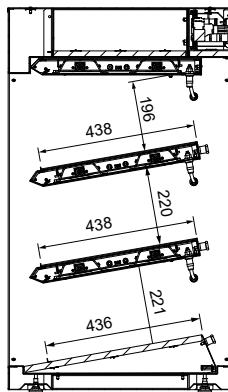

SECTION VIEW

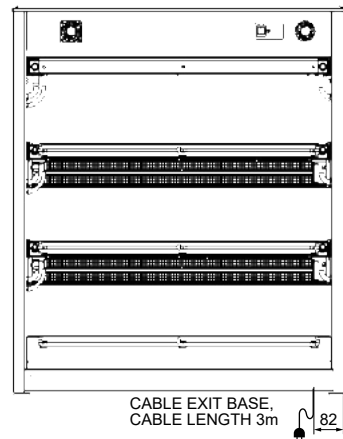

REAR ELEVATION

More information including technical data and installation guidelines is available from the Product Manual published on our website.

In line with our policy to continually develop, improve and support our products, Future Products Group Ltd reserves the right to change specifications and design without notice.

Have a question? Please email us at sales@fpgworld.com or visit www.fpgworld.com for full contact details for your region.



Worldwide contact details: